

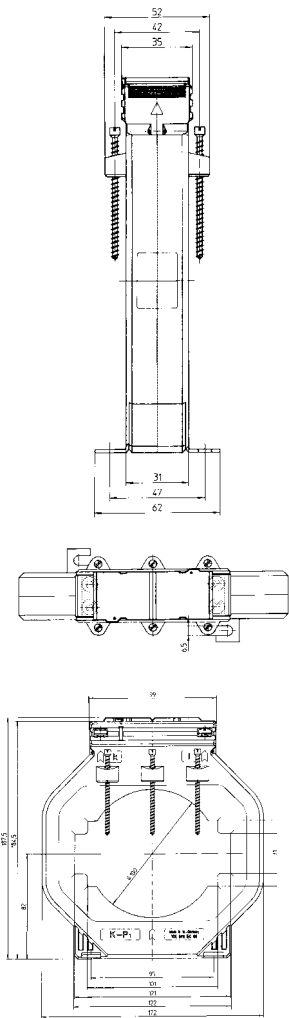

(E)ASK 123.3

Aufsteck-Stromwandler

Plug-in current transformers



ASK Sek.Strom /
sec.current **1A**

E...= zugelassener
Verrechnungsstromwandler
Tariff Current Transformer

Prim. Strom prim. current	VA	Klasse / class 1		Klasse / class 0,5	
		Best.-Nr. order-no.		Best.-Nr. order-no.	
1000	5	24237		24211	
	10	24238		24125	
1200	5	24239		24212	
	10	24240		24213	
	15	24241		24214	
1250	5	24242		24215	
	10	24243		24216	
	15	24244		24217	
1500	5	24245		24218	
	10	24246		24219	
	15	24247		24220	
	30	24248			
1800	5	24249		24221	
	10	24250		24222	
	15	24251		24223	
	30	24252			
2000	5			24224	
	10	24253		24225	
	15	24254		24226	
	30	24255		24227	
	45	24256			
2500	10	24257		24228	
	15	24258		24229	
	30	24259		24230	
	45	24260			
3000	10	24261		24231	
	15	24262		24232	
	30	24263		24233	
	45	24264			
4000	10	24265		24234	
	15	24266		24235	
	30	24267		24236	
	45	24268			

Primärleiter Primary conductor	123 x 30 mm 3 x 100 x 10 mm
Rundleiter Round conductor	Ø 100 mm
Wandlerbreite Transformer width	172 mm
Schnappbefestigung Snap-on mounting	Best.-Nr./order-no. -
Plombierplatte Sealed shutter	Best.-Nr./order-no. 59040

(E)ASK 123.3

Aufsteck-Stromwandler *Plug-in current transformers*

E...= zugelassener Verrechnungsstromwandler
Tariff Current Transformer

		ASK Sek.Strom / sec.current 5A					
Prim. Strom prim. current	VA	Klasse / class 1		Klasse / class 0,5		Klasse / class 0,2s	
		Best.-Nr. order-no.		Best.-Nr. order-no.		Best.-Nr. order-no.	
750	2,5			24127			
	5			24128			
	10			24129			
1000	2,5			24010		V56-2504D	
	5	24037		24011		V56-2504F	
	10	24038		24126			
1200	5	24039		24012		V56-2604F	
	10	24040		24013			
	15	24041		24014			
1250	5	24042		24015		V56-2704F	
	10	24043		24016		V56-2704H	
	15	24044		24017			
1500	5	24045		24018		V56-2804F	
	10	24046		24019		V56-2804H	
	15	24047		24020			
	30	24048		24130			
1600	5	24112				V56-2904F	
	10	24107				V56-2904H	
	15	24113				V56-2904J	
	30	24108		24131			
1800	5	24049		24021			
	10	24050		24022			
	15	24051		24023			
	30	24052					
2000	5			24024		V56-3004F	
	10	24053		24025		V56-3004H	
	15	24054		24026		V56-3004J	
	30	24055		24027			
	45	24056					
2500	5			24136		V56-3204F	
	10	24057		24028		V56-3204H	
	15	24058		24029		V56-3204J	
	30	24059		24030			
	45	24060					
3000	5			24137		V56-3304F	
	10	24061		24031		V56-3304H	
	15	24062		24032		V56-3304J	
	30	24063		24033			
	45	24064					
4000	10	24065		24034			
	15	24066		24035			
	30	24067		24036			
	45	24068					

(E)ASK 123.3**Aufsteck-Stromwandler***Plug-in current transformers*

**E...= zugelassener Verrechnungsstromwandler
Tariff Current Transformer**

		EASK Sek.Strom / sec.current 5A					
Prim. Strom prim. current	VA	Klasse / class 0,5		Klasse / class 0,5s		Klasse / class 0,2	
		Best.-Nr. order-no.		Best.-Nr. order-no.		Best.-Nr. order-no.	
750	2,5	V56-2301D		V56-2302D			
	5	V56-2301F		V56-2302F			
	10	V56-2301H		V56-2302H			
1000	2,5	V56-2501D		V56-2502D		V56-2503D	
	5	V56-2501F		V56-2502F		V56-2503F	
	10	V56-2501H		V56-2502H			
1200	5	V56-2601F		V56-2602F		V56-2603F	
	10	V56-2601H		V56-2602H		V56-2603H	
	15	V56-2601J		V56-2602J			
1250	5	V56-2701F		V56-2702F		V56-2703F	
	10	V56-2701H		V56-2702H		V56-2703H	
	15	V56-2701J		V56-2702J		V56-2703J	
1500	5	V56-2801F		V56-2802F		V56-2803F	
	10	V56-2801H		V56-2802H		V56-2803H	
	15	V56-2801J		V56-2802J		V56-2803J	
	30	V56-2801L		V56-2802L			
1600	5	V56-2901F		V56-2902F		V56-2903F	
	10	V56-2901H		V56-2902H		V56-2903H	
	15	V56-2901J		V56-2902J		V56-2903J	
	30	V56-2901L		V56-2902L			
1800	5						
	10						
	15						
	30						
2000	5	V56-3001F		V56-3002F		V56-3003F	
	10	V56-3001H		V56-3002H		V56-3003H	
	15	V56-3001J		V56-3002J		V56-3003J	
	30	V56-3001L		V56-3002L			
	45						
2500	5	V56-3201F		V56-3202F		V56-3203F	
	10	V56-3201H		V56-3202H		V56-3203H	
	15	V56-3201J		V56-3202J		V56-3203J	
	30	V56-3201L		V56-3202L			
3000	5						
	10	V56-3301F		V56-3302F		V56-3303F	
	15	V56-3301H		V56-3302H		V56-3303H	
	30	V56-3301J		V56-3302J		V56-3303J	
	45	V56-3301L		V56-3302L			